

GENERAL CHARACTERISTICS

For applications where it is necessary to measure pressure, or hydrostatic level with a high grade of accuracy. The power supply to the sensors is between 8 and 36 Vdc, and the output signal is available with 4-20 mA, two-wire technology, which allows to realize remote connections to data acquisition systems with very long lines maintaining a high immunity to electrical noise.

- Two-wire 4-20 mA signal.
- Piezoresistive sensor with ceramic support.
- Degree of protection IP65.



PRESSURE RANGES

Tab.1

Measuring ranges Bar	P max. Bar	Breaking pressure Bar	Code
0 - 2	4	7	0002
0 - 4	10	15	0004
0 - 6	10	15	0006
0 - 10	20	35	0010
0 - 16	40	70	0016
0 - 25	40	70	0025
0 - 40	100	150	0040
0 - 60	100	150	0060
0 - 100	200	250	0100
0 - 200	400	450	0200
0 - 250	400	450	0250
0 - 400	600	650	0400

TECHNICAL DATA

Tab.2

Description		Code		
Measuring element	Piezoresistive with ceramic support.	PC		
Power supply	8 ÷ 36 Vdc - without load	-		
Output signal	4 - 20 mA	420		
	0 - 10 V (●) On request	010		
Max. load	500 Ω - Power supply 18 ÷ 36 Vdc	-		
Mechanical life	10 ⁷ cycles 0÷100% F.S. a 25°C	-		
Linearity ± 0,5 % FS	Accuracy ± 2 % FS	Temperature -25 ÷ 70 °C	Protection IP65	-
Electrical connection	DIN 43650-A plug	S1		
	M12 x 14 - 4 poles plug	S3		
	Automotive Delphi plug	S4		

PROCESS CONNECTION

Tab.3

Dimensions			Male thread			Materials	
08	06	15	G	C	N	B	S
1/4"	1/8"	1/2"	UNI 228/1	UNI 7/1	NPT	Nickel plated brass	S. S. AISI-316
On request			On request				

NOMENCLATURE

TPV	0040	PC	08GB	420	S1	
•						Pressure transmitter
	•					Tab.1 Measuring range
		•				Tab.2 Measuring element
			•			Tab.3 Process connection dimension and material
				•		Tab.2 Output signal
					•	Tab.2 Electrical connection and output
K	PU	02	S	G		2m. length connection cable - M12x1 plug
K	VU	02	S	3		2m. length connection cable - Delphi plug
						Straight version
						Accessory on request

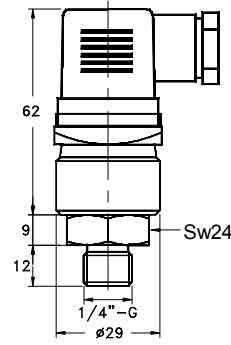

S1

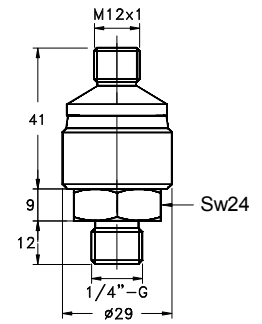

S3

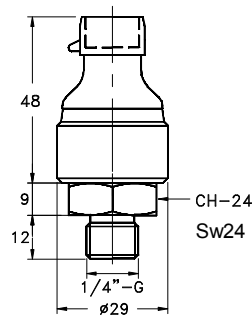

S4

